



## ADJUSTABLE MODULE Ø90

The adjustable FastMill module allows a vertical movement of +/-6mm. It allows you to push and align the workpiece but also to pull it downwards, a condition that is impossible with traditional clamping systems. Featuring a fine pitch M70 thread system, it provides the force you need with the precision you expect.

CODE	DESCRIPTION	HEIGHT	Ø	WEIGHT
FMMSADJ901606	Adjustable module Ø90	160 ± 6 (6,29" ± 0,23")	90 (3,54")	5,1 (11,24 lbs)
FM93000019	Hook wrench 92-95			

### EXTRA FINE PITCH 1° = 5µm

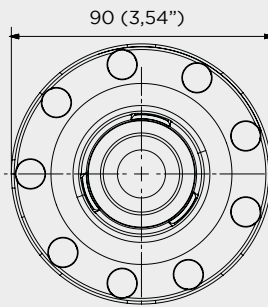
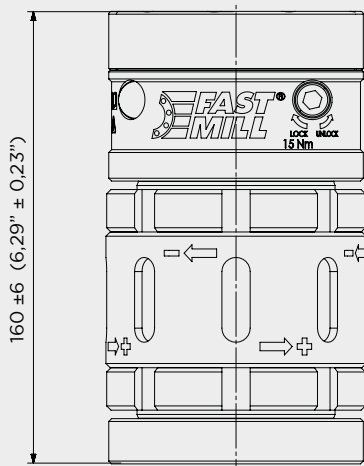

**HOOK WRENCH 92-95**  
FM93000019



## SETUP EXAMPLE

SINGLE MODULE H160  
Code FMX46190140

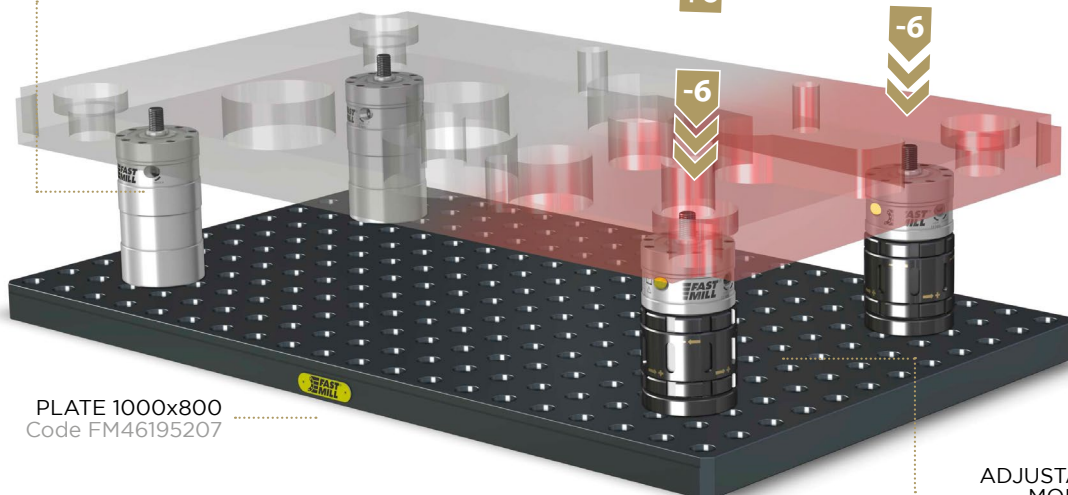



## SELF ADJUSTABLE MODULE Ø90

The FastMill self adjustable module allows a vertical support of +/-6 mm, without generating any tension on the piece. In combination with the adjustable module it can follow the deformations of the piece by working the roughing and finishing in the same work operation.

CODE	DESCRIPTION	HEIGHT	Ø	WEIGHT
FMMSSPR901606	Self adjustable module Ø90	160 ± 6 (6,29" ± 0,23")	90 (3,54")	5,1 (11,24 lbs)

CODE	DESCRIPTION	DIMENSION	TORQUE	WEIGHT
FM93000049KIT	Preset torque wrench hex 6 mm 15 Nm	260 (10,23")	15 Nm	0,5 (11 lbs)
FM9300048B	Hex insert for torque wrench			

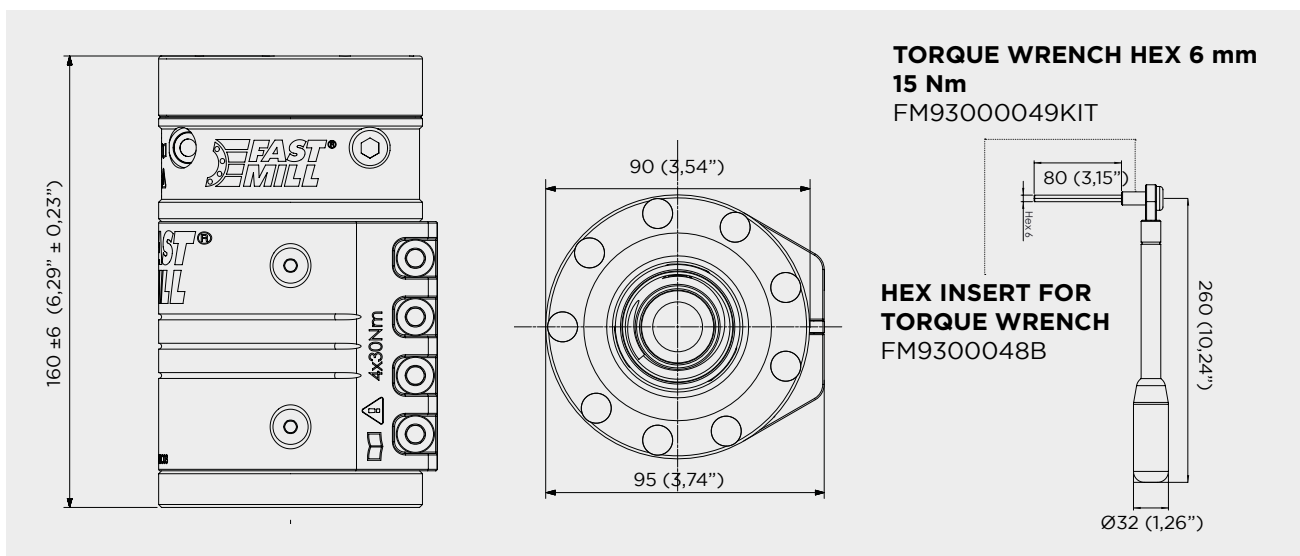

## SETUP EXAMPLE

