

NEW

Anti Pullout collet, PG straight collet

For MEGA Double Power Chuck and Hi Power Milling Chuck

- The unique Key Grip locking mechanism prevents the tool from slipping or pulling out during heavy machining.
- Even if a tool is damaged and cannot be removed from the collet, the collet itself can be disassembled from the holder.
- As it accepts industry standard Weldon flat cutting tool, no special cutting tool is required.

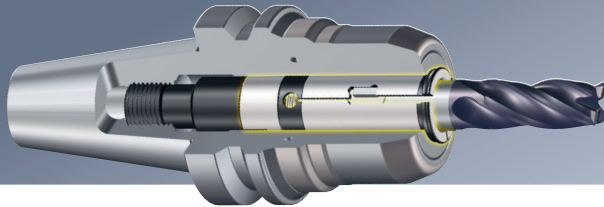

PG Straight Collet

For MEGA20D/20DS and HMC20/20S

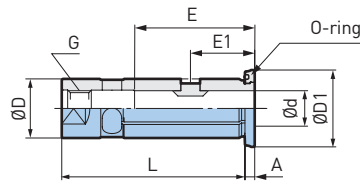
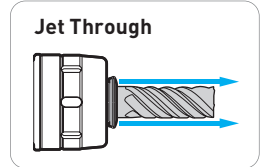

Fig. 1

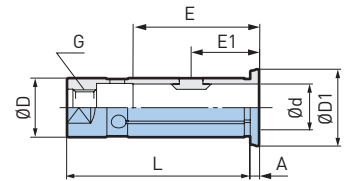
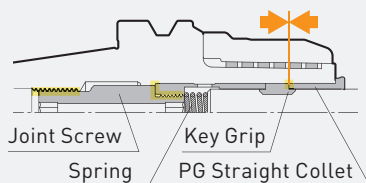

Fig. 2

	Model	Order No.	Fig.	Ød	ØD	ØD1	A	L	E	E1	G
NEW	CPG20-10	101352.001.0	1	10	20	26	3.3	62	38	19	M12×P1.25
NEW	CPG20-12	101352.002.0	1	12	20	26	3.3	62	38	19	M12×P1.25
NEW	CPG20-16	101352.003.0	2	16	20	24	3	62	38	19	M12×P1.25

1. Joint Screw and Joint Adaptor (depends on the models) are required. Please refer to the applicable models chart in next page.
2. 2pcs of Key Grip and 1pce of Spring are included
3. E1 is the distance between the center of Key Grip and top of the PG collet
4. O-ring for PG collet is available as PJC20 OR (806.093)



Anti Pullout mechanism The Key Grip prevent pulling out of the tool and Joint Screw prevent pulling out of the collet.

The Key Grip fits into the groove of the collet to prevent any slip.

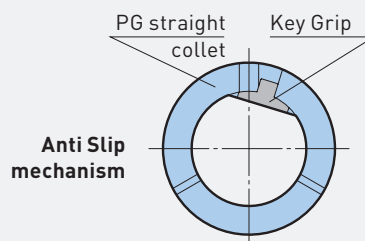

Anti Slip mechanism



Peripheral coolant supply

Joint Screw / Joint Adopter

Joint Screw

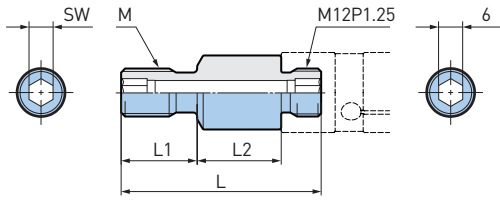

Joint Adopter

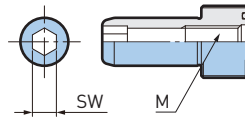

Fig. 1

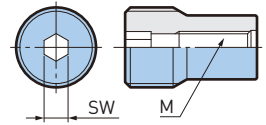
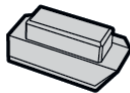

Fig. 2

Applicable tool holder			Joint Screw					Joint Adopter					
Interface	Chuck	L	Model	Order No.	Fig.	SW	M	Model	Order No.	Fig.	SW	M	
(B) BT40 (B) BT50 (B) DV40 (B) DV50	MEGA Double Power chuck (MEGA20D, MEGA20DS)	75~300	JS-M16	101357.005.0	1	6	16	-	-	-	-	-	
HSK-A63		90	JS-M8S	101357.002.0	1	4	8	HSK63-CP-JA	101358.002.0	2	6	8	
		105	JS-M8	101357.001.0									
		120,135											
HSK-A100	Hi Power Milling Chuck HMC20 HMC20S	165	JS-M16	101357.005.0		1	6	16	•	•	-	-	-
		105	JS-M11	101357.003.0	11				HSK100-CP-JA	101358.001.0	2	8	10
		135	JS-M12	101357.004.0									
		165	JS-M16	101357.005.0									
HSK-A125		135	JS-M12	101357.004.0	1	6	12	•	•	-	-	-	
		165	JS-M16	101357.005.0				12	•	•	-	-	-

1. HSK63-CP-JA and HSK-A100-CP-JA can be used as coolant pipe
2. • models can use standard Coolant Pipe. Please order separately.
3. Hexagon wrench is not included
4. PG collet can be used only for above Chuck. (Not applicable for MEGA Perfect Grip)
5. For BIG CAPTO, please contact BIG/BIG KAISER.

Spare Parts



Shank diameter	Key Grip	Order No.	Spring	Order No.	O-Ring	Order No.
Ø10	PKG10-2P	101353.001.0	PSP0921	101354.001.0	PJC20-OR	806.093
Ø12	PKG12-2P	101353.002.0	PSP1117	101354.002.0	PJC20-OR	806.093
Ø16	PKG16-2P	101353.003.0	PSP1519	101354.003.0	-	

1. Key grip is available in a package of 2 pcs.
2. It is recommended to replace the Key Grip regularly.

