

Face Mill Arbor Tipo FMH

Para herramientas que requieren refrigeración a través del eje.

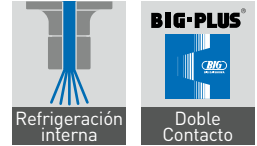

A.1

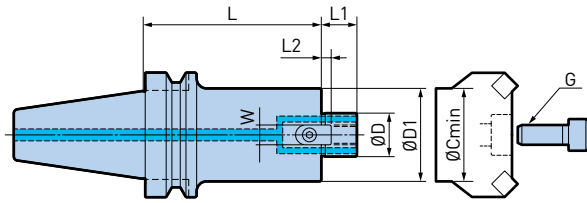
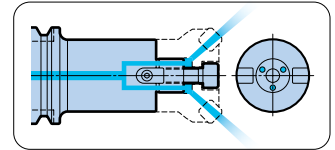

Fig. 1

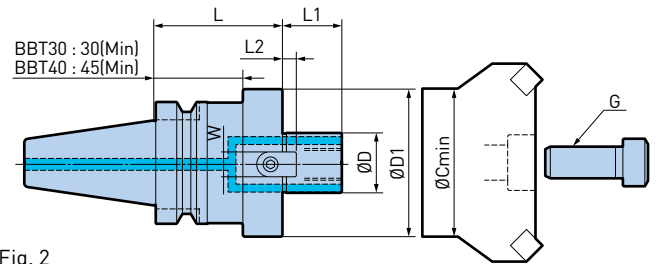

Fig. 2

Modelo	Artículo No.	Fig.	ØD	ØD1	L	L1	L2	W	G	ØC min.	Peso (kg)
BBT30-FMH16-37-35	978.326	1	16	37	35	16	5	8	M8	28	0.52
BBT30-FMH22-45-35	-	1	22	45	35	18	5	10	M10	38	0.60
BBT30-FMH22-47-45	978.259	2	22	47	45	18	5	10	M10	38	0.73
BBT30-FMH22-60-45	805.569	2	22	60	45	18	5	10	M10	38	0.87
BBT30-FMH27-45-35	-	1	27	45	35	20	6	12	M12	38	0.64
BBT30-FMH27-60-45	978.273	2	27	60	45	20	6	12	M12	46	0.91
BBT40-FMH16-37-40	800.066	1	16	37	40	16	5	8	M8	28	1.10
BBT40-FMH22-47-45	978.145	1	22	47	45	18	5	10	M10	38	1.30
BBT40-FMH22-47-60	978.324	1	22	47	60	18	5	10	M10	36	1.50
BBT40-FMH22-47-90	800.074	1	22	47	90	18	5	10	M10	36	1.90
BBT40-FMH22-47-150	978.378	1	22	47	150	18	5	10	M10	36	2.60
BBT40-FMH22-60-45	978.368	1	22	60	45	18	5	10	M10	38	1.40
BBT40-FMH22-60-60	800.075	1	22	60	60	18	5	10	M10	38	1.80
BBT40-FMH22-60-90	978.208	1	22	60	90	18	5	10	M10	38	2.40
BBT40-FMH27-60-45	978.219	1	27	60	45	20	6	12	M12	46	1.50
BBT40-FMH27-60-60	800.079	1	27	60	60	20	6	12	M12	46	1.80
BBT40-FMH27-60-90	978.128	1	27	60	90	20	6	12	M12	46	2.40
BBT40-FMH27-76-60	800.080	2	27	76	60	20	6	12	M12	48	2.00
BBT40-FMH27-76-90	800.081	2	27	76	90	20	6	12	M12	48	2.70
BBT40-FMH32-96-60	978.035	2	32	96	60	22	7	14	M16	58	2.40

Modelo	Artículo No.	Fig.	ØD	ØD1	L	L1	L2	W	G	ØC min.	Peso (kg)
BBT50-FMH16-37-60	800.207	1	16	37	60	16	5	8	M8	28	3.80
BBT50-FMH16-37-105	800.204	1	16	37	105	16	5	8	M8	28	4.10
BBT50-FMH16-37-150	800.205	1	16	37	150	16	5	8	M8	28	4.50
BBT50-FMH16-37-200	800.206	1	16	37	200	16	5	8	M8	28	4.80
BBT50-FMH22-47-60	978.129	1	22	47	60	18	5	10	M10	38	3.90
BBT50-FMH22-47-105	978.130	1	22	47	105	18	5	10	M10	36	4.50
BBT50-FMH22-47-150	978.131	1	22	47	150	18	5	10	M10	36	5.10
BBT50-FMH22-47-200	978.148	1	22	47	200	18	5	10	M10	36	5.70
BBT50-FMH22-47-250	800.221	1	22	47	250	18	5	10	M10	36	6.40
BBT50-FMH22-47-300	800.222	1	22	47	300	18	5	10	M10	36	7.00
BBT50-FMH22-47-350	800.223	1	22	47	350	18	5	10	M10	36	7.70
BBT50-FMH22-60-60	978.403	1	22	60	60	18	5	10	M10	38	4.10
BBT50-FMH22-60-105	978.167	1	22	60	105	18	5	10	M10	38	5.10
BBT50-FMH22-60-150	800.224	1	22	60	150	18	5	10	M10	38	6.00
BBT50-FMH22-60-200	800.225	1	22	60	200	18	5	10	M10	38	7.10
BBT50-FMH22-60-250	978.141	1	22	60	250	18	5	10	M10	38	8.20
BBT50-FMH22-60-300	800.226	1	22	60	250	18	5	10	M10	38	9.30
BBT50-FMH22-60-350	800.227	1	22	60	350	18	5	10	M10	38	10.30
BBT50-FMH27-60-45	800.237	1	27	60	45	20	6	12	M12	46	3.90
BBT50-FMH27-60-90	978.174	1	27	60	90	20	6	12	M12	46	4.80
BBT50-FMH27-60-150	978.175	1	27	60	150	20	6	12	M12	46	6.10
BBT50-FMH27-60-200	800.235	1	27	60	200	20	6	12	M12	46	7.10
BBT50-FMH27-60-250	978.029	1	27	60	250	20	6	12	M12	46	8.20
BBT50-FMH27-60-300	800.236	1	27	60	300	20	6	12	M12	46	9.30
BBT50-FMH27-76-45	978.341	1	27	76	45	20	6	12	M12	48	4.00
BBT50-FMH27-76-90	978.168	1	27	76	90	20	6	12	M12	48	5.50
BBT50-FMH27-76-150	978.142	1	27	76	150	20	6	12	M12	48	7.60
BBT50-FMH27-76-200	800.238	1	27	76	200	20	6	12	M12	48	9.30
BBT50-FMH27-76-250	800.239	1	27	76	250	20	6	12	M12	48	11.10
BBT50-FMH27-76-300	800.240	1	27	76	240	20	6	12	M12	48	12.80
BBT50-FMH32-96-45	978.132	1	32	96	45	22	7	14	M16	58	4.20
BBT50-FMH32-96-90	978.133	1	32	96	90	22	7	14	M16	58	6.60
BBT50-FMH32-96-150	978.143	1	32	96	150	22	7	14	M16	58	10.00
BBT50-FMH32-96-200	978.183	1	32	96	200	22	7	14	M16	58	12.80
BBT50-FMH32-96-250	800.255	1	32	96	250	22	7	14	M16	58	15.60
BBT50-FMH32-96-300	800.256	1	32	96	300	22	7	14	M16	80	18.30
BBT50-FMH40-100-45	978.149	1	40	100	45	26	8.5	16	M20 (MBA-M20H)	70	4.50
BBT50-FMH40-100-75	961.371	1	40	100	75	26	8.5	16	M20(MBA-M20H)	70	6.20
BBT50-FMH40-100-105	961.372	1	40	100	105	26	8.5	16	M20(MBA-M20H)	70	8.00

1. Pueden utilizarse portaherramientas BIG-PLUS® en centros de mecanizado con husillos DV convencionales.
2. Se incluye el tornillo de cabeza hexagonal.
3. Al usar un tornillo de sujeción con un agujero interno, el refrigerante se suministra a través del tornillo.

Accesorios & Recambios

<p>Tornillos de sujeción</p>  <p>► 372</p>	<p>Fullcut Mill FCM - Arbor Type</p>  <p>► 479</p>
---	---

Face Mill Arbor Tipo FMH

Para herramientas que requieren refrigeración a través del eje.

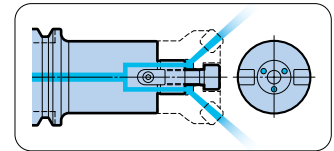
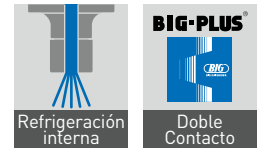

A.2

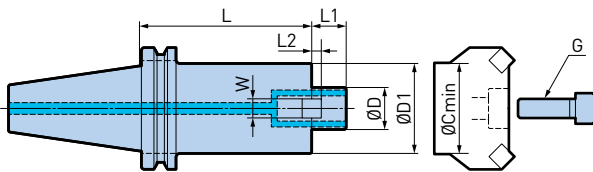

Fig. 1

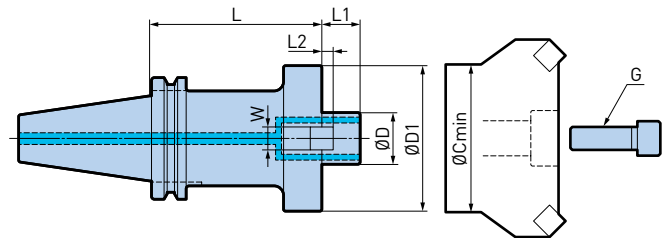

Fig. 2

Modelo	Artículo No.	Fig.	ØD	ØD1	L	L1	L2	W	G	ØC min.	Peso (kg)
BDV40-FMH16-37-40	806.896	1	16	37	40	16	5	8	M8	28	1.00
BDV40-FMH22-47-45	805.584	1	22	47	45	18	5	10	M10	38	1.20
BDV40-FMH22-47-60	807.208	1	22	47	60	18	5	10	M10	38	1.50
BDV40-FMH22-47-90	805.585	1	22	47	90	18	5	10	M10	36	1.80
BDV40-FMH22-47-150	805.604	1	22	47	150	18	5	10	M10	36	2.60
BDV40-FMH22-60-50	805.605	2	22	60	50	18	5	10	M10	38	1.50
BDV40-FMH22-60-90	805.606	2	22	60	90	18	5	10	M10	38	2.00
BDV40-FMH27-60-50	805.586	2	27	60	50	20	6	12	M12	46	1.50
BDV40-FMH27-60-90	805.608	2	27	60	90	20	6	12	M12	46	2.00
BDV40-FMH27-76-60	805.609	2	27	76	60	20	6	12	M12	48	1.90
BDV40-FMH27-76-90	805.610	2	27	76	90	20	6	12	M12	48	2.30
BDV40-FMH32-96-60	805.611	2	32	96	60	22	7	14	M16	58	2.30

continúa en la página siguiente



Face Mill Arbor Tipo FMH

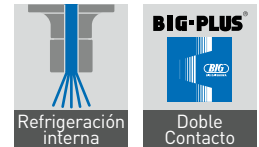

A.2

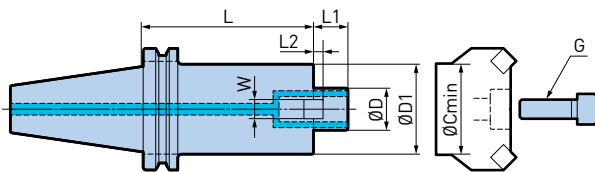

Fig. 1

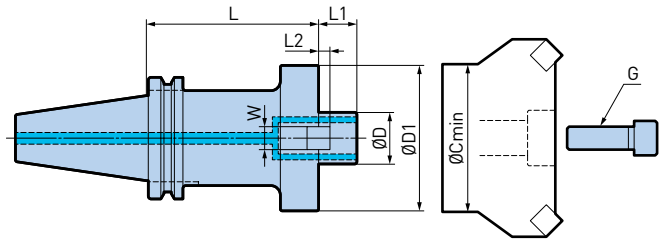

Fig. 2

Modelo	Artículo No.	Fig.	ØD	ØD1	L	L1	L2	W	G	ØC min.	Peso (kg)
BDV50-FMH16-37-105	807.209	1	16	37	105	16	5	8	M8	28	3.30
BDV50-FMH22-47-60	805.758	1	22	47	60	18	5	10	M10	38	3.20
BDV50-FMH22-47-105	805.623	1	22	47	105	18	5	10	M10	36	3.80
BDV50-FMH22-47-150	805.624	1	22	47	150	18	5	10	M10	36	4.40
BDV50-FMH22-47-200	978.226	1	22	47	200	18	5	10	M10	36	5.00
BDV50-FMH22-47-250	807.210	1	22	47	250	18	5	10	M10	36	5.60
BDV50-FMH22-60-60	805.626	1	22	60	60	18	5	10	M10	38	3.50
BDV50-FMH22-60-105	805.627	1	22	60	105	18	5	10	M10	38	4.50
BDV50-FMH22-60-150	805.628	1	22	60	150	18	5	10	M10	38	5.50
BDV50-FMH22-60-200	805.629	1	22	60	200	18	5	10	M10	38	6.50
BDV50-FMH27-60-45	805.630	1	27	60	45	20	6	12	M12	46	3.30
BDV50-FMH27-60-90	805.631	1	27	60	90	20	6	12	M12	46	4.20
BDV50-FMH27-60-150	805.632	1	27	60	150	20	6	12	M12	46	5.50
BDV50-FMH27-60-200	805.633	1	27	60	200	20	6	12	M12	46	6.50
BDV50-FMH27-76-45	805.635	1	27	76	45	20	6	12	M12	48	3.60
BDV50-FMH27-76-90	805.636	1	27	76	90	20	6	12	M12	48	5.10
BDV50-FMH27-76-150	805.637	1	27	76	150	20	6	12	M12	48	7.20
BDV50-FMH27-76-200	805.638	1	27	76	200	20	6	12	M12	48	9.00
BDV50-FMH32-96-50	805.639	2	32	96	50	22	7	14	M16	58	4.20
BDV50-FMH32-96-90	805.640	2	32	96	90	22	7	14	M16	58	6.30
BDV50-FMH32-96-150	805.641	2	32	96	150	22	7	14	M16	58	8.50
BDV50-FMH32-96-200	805.642	2	32	96	200	22	7	14	M16	58	12.40
BDV50-FMH40-100-50	805.643	2	40	100	50	26	8.5	16	M20	70	4.60
BDV50-FMH40-100-75	805.644	2	40	100	75	26	8.5	16	M20	70	5.90
BDV50-FMH40-100-105	805.645	2	40	100	105	26	8.5	16	M20	70	7.20

1. Pueden utilizarse portaherramientas BIG-PLUS® en centros de mecanizado con husillos DV convencionales.
2. Se incluye el tornillo de cabeza hexagonal.
3. Al usar un tornillo de sujeción con un agujero interno, el refrigerante se suministra a través del tornillo.

Accesorios & Recambios

Tornillos de sujeción



► 372

Face Mill Arbor Tipo FMH

Para herramientas que requieren refrigeración a través del eje.

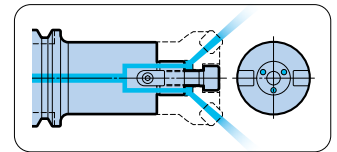

A.3

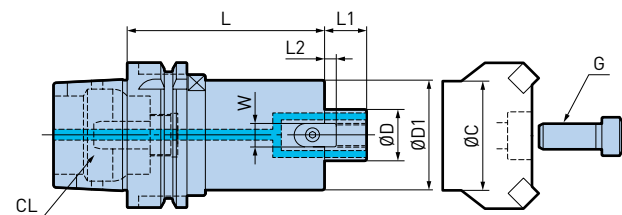

Fig. 1

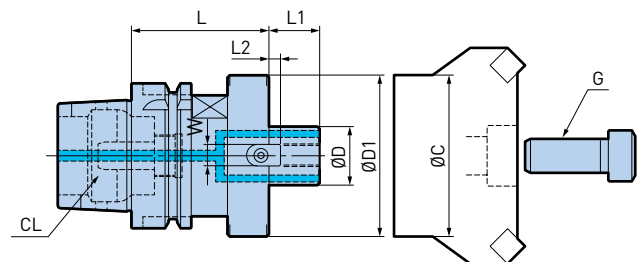

Fig. 2

Modelo	Artículo No.	Fig.	ØD	ØD1	L	L1	L2	W	G	ØC min.	Peso (kg)
HSK-A50-FMH22-47-60	805.833	2	22	47	60	18	5	10	M10	36	0.90
HSK-A50-FMH22-47-90	807.246	2	22	47	90	18	5	10	M10	36	1.20
HSK-A50-FMH27-60-60	805.834	2	27	60	60	20	6	12	M12	46	1.00
HSK-A50-FMH27-60-90	807.247	2	27	60	90	20	6	12	M12	46	1.40
HSK-A63-FMH16-37-45	979.194	1	16	37	45	16	5	8	M8	28	0.90
HSK-A63-FMH22-47-60	801.189	1	22	47	60	18	5	10	M10	36	1.20
HSK-A63-FMH22-47-90	978.186	1	22	47	90	18	5	10	M10	36	1.60
HSK-A63-FMH22-47-150	801.188	1	22	47	150	18	5	10	M10	36	2.40
HSK-A63-FMH22-60-60	805.573	2	22	60	60	18	5	10	M10	38	1.40
HSK-A63-FMH22-60-90	805.574	2	22	60	90	18	5	10	M10	38	1.90
HSK-A63-FMH27-60-60	978.185	2	27	60	60	20	6	12	M12	46	1.40
HSK-A63-FMH27-60-90	979.196	2	27	60	90	20	6	12	M12	46	1.90
HSK-A63-FMH32-96-60	805.646	2	32	96	60	22	7	14	M16	58	2.00

continúa en la página siguiente



Face Mill Arbor Tipo FMH

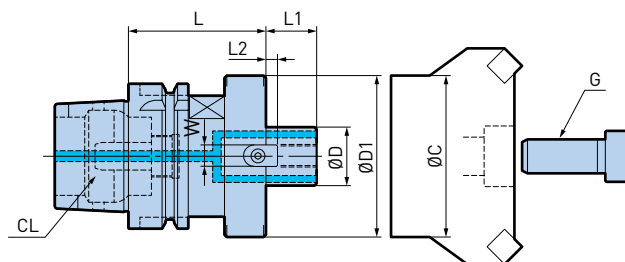
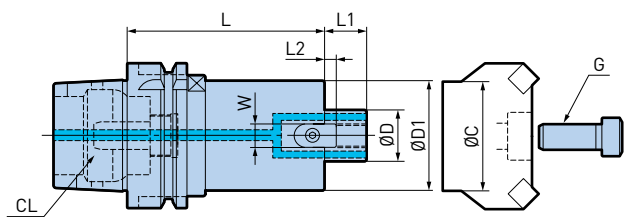

Fig. 1

Fig. 2

A.3

Modelo	Artículo No.	Fig.	ØD	ØD1	L	L1	L2	W	G	ØC min.	Peso (kg)
HSK-A100-FMH22-47-105	965.523	1	22	47	105	18	5	10	M10	36	3.20
HSK-A100-FMH22-47-150	978.120	1	22	47	150	18	5	10	M10	36	3.80
HSK-A100-FMH22-47-200	978.121	1	22	47	200	18	5	10	M10	36	4.50
HSK-A100-FMH22-47-250	801.091	1	22	47	250	18	5	10	M10	36	5.10
HSK-A100-FMH22-60-60	801.096	1	22	60	60	18	5	10	M10	38	3.00
HSK-A100-FMH22-60-105	801.092	1	22	60	105	18	5	10	M10	38	3.90
HSK-A100-FMH22-60-150	801.093	1	22	60	150	18	5	10	M10	38	4.90
HSK-A100-FMH22-60-200	801.094	1	22	60	200	18	5	10	M10	38	6.00
HSK-A100-FMH22-60-250	801.095	1	22	60	250	18	5	10	M10	38	7.00
HSK-A100-FMH27-60-60	801.102	1	27	60	60	20	6	12	M12	46	2.90
HSK-A100-FMH27-60-90	801.103	1	27	60	90	20	6	12	M12	46	3.60
HSK-A100-FMH27-60-150	801.101	1	27	60	150	20	6	12	M12	46	4.90
HSK-A100-FMH27-60-200	807.130	1	27	60	200	20	6	12	M12	46	6.00
HSK-A100-FMH27-60-250	807.114	1	27	60	250	20	6	12	M12	46	7.10
HSK-A100-FMH27-76-60	801.105	1	27	76	60	20	6	12	M12	62	3.30
HSK-A100-FMH27-76-90	801.106	1	27	76	90	20	6	12	M12	62	4.40
HSK-A100-FMH27-76-150	801.104	1	27	76	150	20	6	12	M12	62	6.50
HSK-A100-FMH32-96-60	801.118	2	32	96	60	22	7	14	M16	80	3.70
HSK-A100-FMH32-96-90	801.119	2	32	96	90	22	7	14	M16	80	5.30
HSK-A100-FMH32-96-150	801.117	2	32	96	150	22	7	14	M16	80	8.50
HSK-A100-FMH40-100-75	801.125	2	40	100	75	26	8.5	16	M20 (MBA-M20H)	80	5.00
HSK-A100-FMH40-100-105	801.124	2	40	100	105	26	8.5	16	M20 (MBA-M20H)	80	6.40
HSK-A125-FMH22A-49-50	806.585	1	22	49	50	18	5	10	M10	40	4.10
HSK-A125-FMH22A-49-100	806.586	1	22	49	100	18	5	10	M10	40	4.80
HSK-A125-FMH22A-49-150	806.587	1	22	49	150	18	5	10	M10	40	5.40
HSK-A125-FMH22A-49-200	806.588	1	22	49	200	18	5	10	M10	36	6.70
HSK-A125-FMH27A-60-90	806.589	1	27	60	90	20	6	12	M12	46	5.00
HSK-A125-FMH27A-60-150	806.590	1	27	60	150	20	6	12	M12	46	6.30
HSK-A125-FMH32A-78-60	806.591	1	32	78	60	22	7	14	M16	58	4.80
HSK-A125-FMH32A-96-105	806.592	1	32	96	105	22	7	14	M16	58	7.90
HSK-A125-FMH40A-80-90	806.593	1	40	80	90	26	8.5	16	M20 (MBA-M20H)	70	6.30

1. Se incluye el tornillo de cabeza hexagonal.
2. Al usar un tornillo de sujeción con un agujero interno, el refrigerante se suministra a través del tornillo.
3. El tubo para refrigerante (CL) hay que pedirlo por separado.

Accesorios & Recambios

<p>Tornillos de sujeción</p>  <p>► 372</p>	<p>Tubos para refrigerante Tipo A/E</p>  <p>► 250</p>
---	--

Face Mill Arbor Tipo FMH

Para herramientas que requieren refrigeración a través del eje.

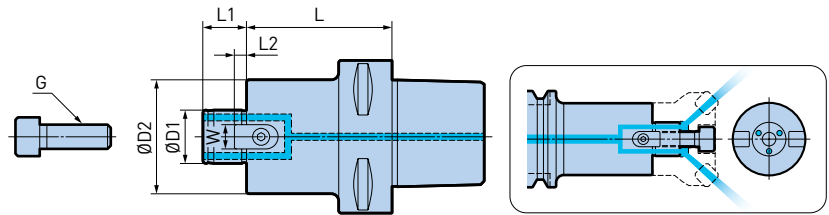

A.4

Modelo	Artículo No.	ØD1	ØD2	L	L1	L2	W	G	ØC min.	Peso (kg)
C4-FMH22-47-45	100153.001.0	22	47	45	18	5	10	M10	38	0.62
C5-FMH22-47-60	973.718	22	47	60	18	5	10	M10	36	1.00
C5-FMH22-47-90	800.695	22	47	90	18	5	10	M10	36	1.40
C5-FMH22-60-60	973.720	22	60	60	18	5	10	M10	38	1.20
C5-FMH27-60-60	800.698	27	60	60	20	6	12	M12	46	1.20
C6-FMH22-47-45	973.721	22	47	45	18	5	10	M10	38	1.10
C6-FMH22-47-60	973.722	22	47	60	18	5	10	M10	36	1.30
C6-FMH22-47-90	973.723	22	47	90	18	5	10	M10	36	1.70
C6-FMH22-47-150	800.783	22	47	150	18	5	10	M10	36	2.50
C6-FMH22-60-45	973.724	22	60	45	18	5	10	M10	38	1.30
C6-FMH22-60-60	973.725	22	60	60	18	5	10	M10	38	1.70
C6-FMH22-60-90	973.726	22	60	90	18	5	10	M10	38	2.30
C6-FMH27-60-45	800.788	27	60	45	20	6	12	M12	46	1.40
C6-FMH27-60-60	800.789	27	60	60	20	6	12	M12	46	1.70
C6-FMH27-60-90	800.790	27	60	90	20	6	12	M12	46	2.30
C6-FMH27-60-150	800.787	27	60	150	20	6	12	M12	46	3.60
C8-FMH22-47-60	973.727	22	47	60	18	5	10	M10	36	2.20
C8-FMH22-47-105	973.728	22	47	105	18	5	10	M10	36	2.80
C8-FMH22-47-150	973.729	22	47	150	18	5	10	M10	36	3.30
C8-FMH22-47-200	800.899	22	47	200	18	5	10	M10	36	4.00
C8-FMH22-60-60	973.730	22	60	60	18	5	10	M10	38	2.50
C8-FMH22-60-105	973.731	22	60	105	18	5	10	M10	38	3.40
C8-FMH22-60-150	973.732	22	60	150	18	5	10	M10	38	4.40
C8-FMH27-60-60	800.906	27	60	60	20	6	12	M12	46	2.50
C8-FMH27-60-105	800.903	27	60	105	20	6	12	M12	46	3.40
C8-FMH27-60-150	800.904	27	60	150	20	6	12	M12	46	4.20
C8-FMH27-60-200	800.905	27	60	200	20	6	12	M12	46	5.50
C8-FMH32-96-75	800.912	32	96	75	22	7	14	M16	58	4.00
C8-FMH32-96-105	800.910	32	96	105	22	7	14	M16	58	5.20
C8-FMH32-96-150	800.911	32	96	150	22	7	14	M16	58	6.80

1. Al usar un tornillo de sujeción con un agujero interno, el refrigerante se suministra a través del tornillo.
2. Se incluye el tornillo de cabeza hexagonal.

Accesorios & Recambios

Tornillos de sujeción



► 372